

<b>DEVELOPMENT SUMMARY:</b> TOTAL SITE AREA - 490.40sqm PERMISSIBLE GFA - 245.20sqm EXISTING GFA - 241.76sqm PROPOSED ADDED GFA - n.a.sqm TOTAL GROSS FLOOR AREA (GFA) - 241.76sqm PERMISSIBLE FSR - 1:0.5 ACHIEVED FSR - 1:0.49	PERMISSIBLE SITE COVERAGE - 50% of TSA ACHIEVED SITE COVERAGE - 146.85sqm COVERED VERANDAH & PORCH - 30% of TSA - 28.15sqm	MIN. LANDSCAPE AREA - n.a.sqm PROPOSED LANDSCAPE AREA (1+2+3+4+5+6) - 214.10sqm PROPOSED DEEP SOIL ZONE (4mX4m minimum dimension) - 165sqm	MIN. POS AREA DIMENSION 5m (MIN) - 80sqm PROPOSED POS AREA - 197sqm (@ 40%)	TOTAL PROPOSED IMPERVIOUS AREA - 276.30sqm (56 % OF TSA) TOTAL BUILDUP AREA - n.a.sqm (n.a. % OF TSA)
---	---	--	---	--

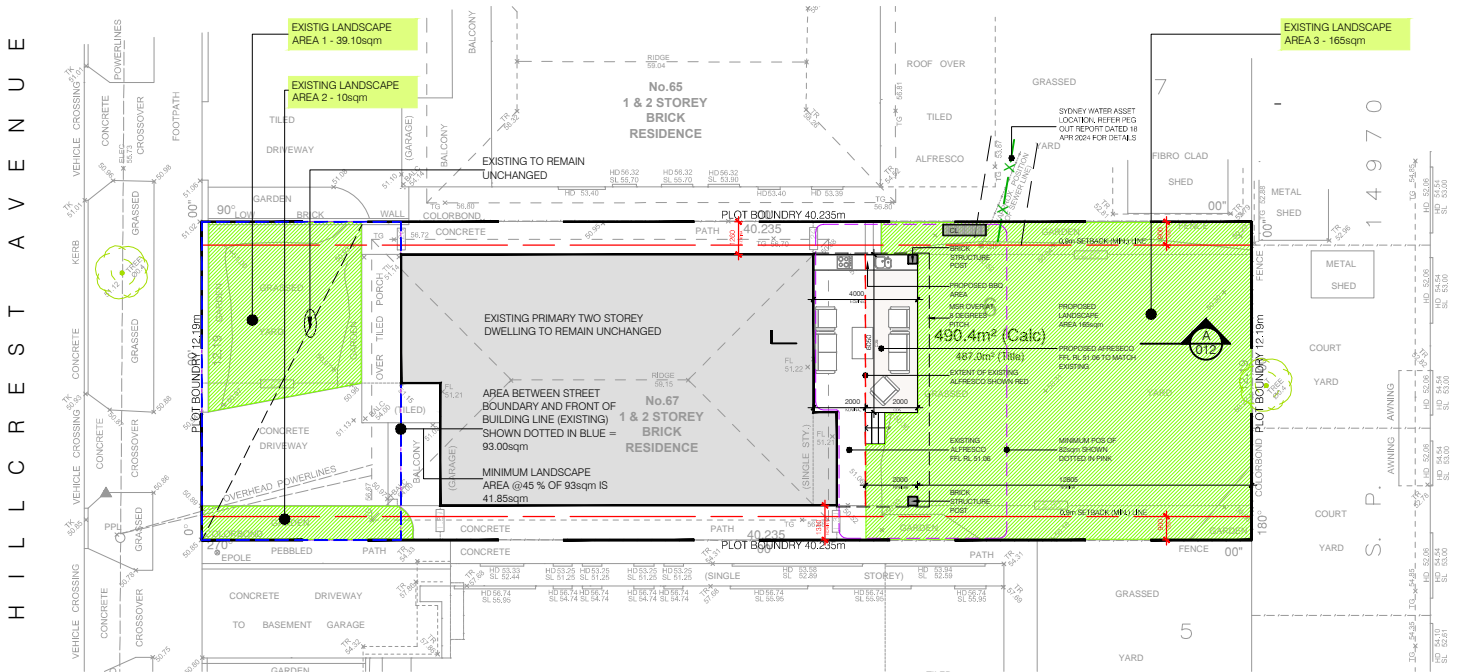

NOT FOR CONSTRUCTION

1 PROPOSED SITE PLAN  
SCALE 1:200

DEVELOPMENT APPLICATION (DA) & CONSULTANTS COORDINATION

<b>RHIZ ME</b> a&k engineering group Address: 117 Robinson Road, Greenacre NSW 2190 Tel: 02 9500 0000 Fax: 02 9500 0000 A.S. CIVIL, P. LAND, S. STRUCT, P. MECH, M.E. PLUMB, CHAS, CIVIL & STRUCTURAL CONSULTANTS	Rev: A	Notes: DA ISSUE	Date: 18.09.24	Project: Proposed Alts & Adds 67 Hillcrest Avenue Greenacre NSW 2190	Drawing Title: NOTIFICATION PLAN				Job No. 048/24	Dwg No. 003	Rev. A
				Client: A&K ENGINEERING GROUP P/L	Drawn by: ST/AK	Date: 15.04.24	Scale: AS SHOWN @ A4		15 SHEETS	OF 15	